



# Model 3

## Compound Leverage Arbor Press

### Instruction and Parts list

### MODEL 3

<u>Item</u>	<u>Part Name</u>	<u>Part No.</u>
1	Frame	235
2	Ram Cap	261
3	Table Plate (263)	701227
4	Compound	272
5	Leverweight	273
6	Pawl	274
7	Ram (2" x 2" x 24")	275
8	Hand Brake	277
9	Hand Brake Clamp	278
10	Compound Rest Pin	280
11	Handle	283
12	Pawl Pin	284
13	Leverweight Pin	285
14	Long Sliding Pin (1" x 10-1/2")	286
15	Short Sliding Pin (1" x 6-1/4")	288
16	Hand Brake Stud (1/2" x 4")	289
17	Spindle	290
18	Handwheel	294

***Please contact factory for current prices.***

**Ordering information:** Please order all repair parts by part number and name, also mention model number of press. All parts are shipped F.O.B. Factory in Grand Haven, MI.

**Lubrication:** Keep all working parts of the press well oiled for easier operation. Also keep a light film of oil over the entire surface of the ram to prevent rust.

## DAKE

Division of JSJ Corp.  
724 Robbins Road  
Grand Haven, MI 49417

Phone: 616-842-7110 800-937-3253  
Fax: 616-842-0859 800-846-3253  
E-Mail: [customerservice@dakecorp.com](mailto:customerservice@dakecorp.com)  
[technicalservice@dakecorp.com](mailto:technicalservice@dakecorp.com)  
Website: [www.dakecorp.com](http://www.dakecorp.com)

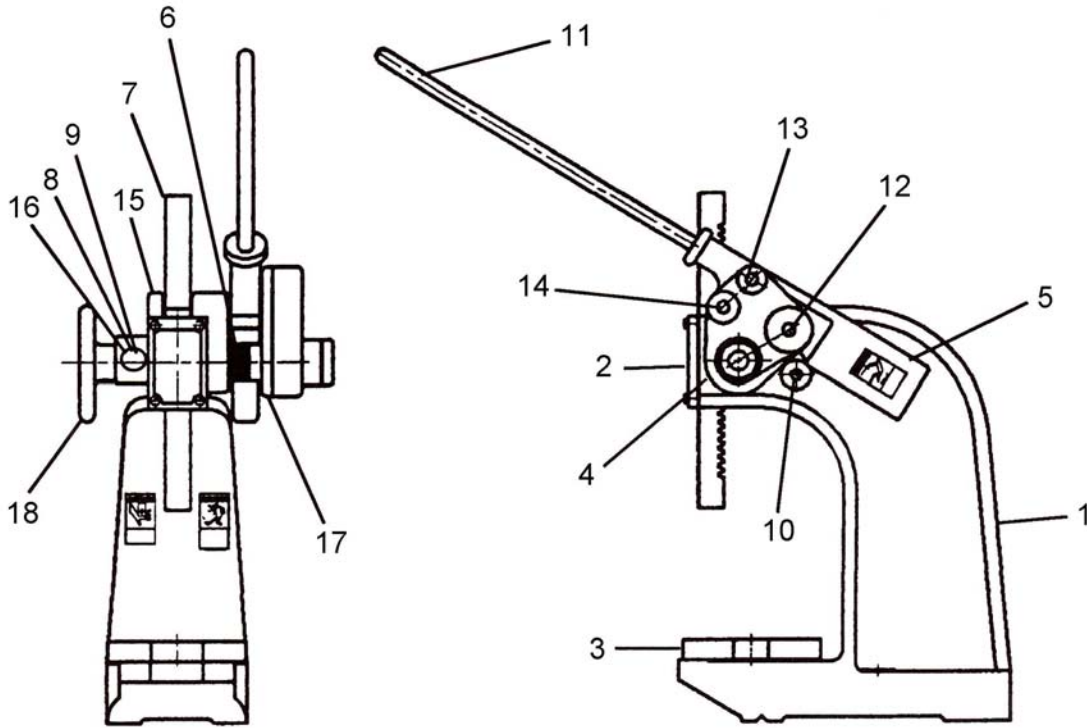

## SAFETY

**This is the safety alert symbol.** When you see this symbol on your press, be alert to the potential for personal injury.

### Follow recommended precautions and safe operating practices.

**Carefully read all safety messages in these instructions and on your press safety signs.** Keep safety labels in good condition. Replace missing or damaged safety labels.

**This machine is intended to be operated by one person.** This person should be conscious of the press ram movement not only for themselves but also for persons in the immediate area of the machine.

**Under no circumstances increase the leverage ratio of the press by using a longer handle or by placing a pipe over the handle.** Never hammer on top of the ram.